



# ViO35-7

TRUE ZERO TAIL SWING MINI EXCAVATOR



## Power-Packed Versatility: Your Go-To Machine.

The 24.4-horsepower Yanmar ViO35-7 mini excavator is powered by a Tier 4 Final Yanmar engine. The 3.5-ton-class machine is a flexible and robust workhorse with high power for its 8,047-pound size, making it easy, reliable and efficient to operate in applications such as construction, rental, utility, landscaping and more. Operators accomplish more with increased productivity from the ViO35-7's three-pump system which provides greater performance over one-pump excavators. The robust machine is built with the operator top of mind, featuring leading 360-degree visibility, ample foot space, comfortable seat and ergonomic controls. The ViO35-7 is backed by a 4-year/4,000-hour warranty – nearly double the traditional mini excavator warranty.

### QUICK SPECS

Weight	Horsepower	Max Dig Depth
8,047 lbs	24.4 hp	10'8"

### INNOVATIVE FEATURES



#### Configurable to Match Your Work

Tailor the ViO35-7 to your application with numerous configuration options. Choose between canopy and cab and between rubber and steel tracks. Also, improve versatility with an optional new second auxiliary circuit. Additionally, straight and angle blade options further expand customization options.

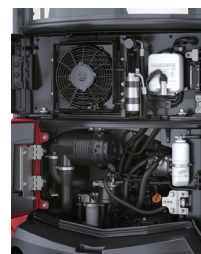

#### Built for Tough Jobs

Like other Yanmar mini excavators, Yanmar designed the ViO35-7 with a robust build and guarding in every possible location. That includes a highly durable undercarriage, cylinder guards, hose guards, strategic placement of the boom light and more.



#### Convenience-Boosting Technology

New machine owners benefit from five years of free Yanmar SmartAssist Remote telematics. Features include error detection, real-time location and operational status updates, daily work reports and more. The ViO35-7's advanced 4.3-inch color display adds convenience and usability, putting a variety of options and information at your fingertips.

**Specifications**

Model			ViO35-7	
Type			Canopy	Cabin
<b>Operating Weight</b>	Rubber track	lbs (t)	7,705 (3.49)	8,047 (3.65)
	Steel track	lbs (t)	7,948 (3.61)	8,289 (3.76)
<b>Engine</b>	Type	-	Vertical 3-cylinder water-cooled direct injection diesel engine	
	Model	-	3TNV88F-ESBV4	
	Rated Output	HP (kW)/rpm	24.4 (18.2) / 2,200	
<b>Performance</b>	Max Digging Force, Bucket / Arm	lbs (kN)	4,564 (20.3)*	
	Traveling Speed, High / Low	MPH (km / h)	3.0 (4.8) / 1.8 (2.9)	
	Swing Speed	RPM	9.4	
	Boom Swing Angle, (L / R)	degrees	71 / 52	
<b>Ground Contact Pressure (Rubber Track)</b>		PSI (kPa)	4.44 (30.6)	4.64 (32.0)
<b>Hydraulic System</b>	Pump Capacity	GPM (L / min)	9.9 (37.4) × 2 <Variable displacement pump> 7.1 (26.8) × 1, 2.6 (9.9) × 1 <Gear pump>	
	Main Relief Set Pressure	PSI (MPa)	3,205 (22.1) × 2,988 (20.6) × 1	
<b>Blade Dimensions</b>	Width	ft-in (mm)	5' 8" (1,740)	
	Stroke, Raise / Lower from G.L.	ft-in (mm)	1' 5" (425) / 1' 3" (370)	
<b>Fuel Tank Capacity</b>		Gals (L)	11.6 (44)	

\*without quick coupler

**Standard Equipment**

- Hydraulic Quick Coupler\*
- Backfill Dozer Blade
- Boom Swing Function
- Rubber Tracks
- Arm End Auxiliary Valve
- Back Mirror
- 2-way Pattern Control
- ROPS / FOPS Canopy, Cabin
- Windshield Washer
- Joystick Pilot Controls
- Arm Rests (Adjustable)
- Suspension and Reclining Seat
- Seat Belt
- Proportional Auxiliary Hydraulics Control
- Dual Speed Switch
- Auto Deceleration Switch
- Eco Mode Switch
- Engine Stop Switch
- Traveling Alarm
- Floor Mats

\*Also available without Quick Coupler.

Please note that the standard equipment may vary from this list. Consult your Yanmar dealer for confirmation.

**Hydraulic PTO**

Model		ViO35-7		
Specification	Output	PSI (MPa)	GPM (L / min)	
			2,200RPM	1,100RPM
<b>Combined Flow, Double Actions</b>		3,205 (22.1)	16.7 (63.2)	8.35 (31.6)

**Lifting Capacity**

LIFT POINT HEIGHT h:in (mm)	r:REACH in (mm)											
	RATED LIFT CAPACITY OVER END BLADE DOWN				RATED LIFT CAPACITY OVER END BLADE UP				RATED LIFT CAPACITY OVER SIDE BLADE UP			
	MAX	137.8 (3,500)	118.1 (3,000)	98.5 (2,500)	MAX	137.8 (3,500)	118.1 (3,000)	98.5 (2,500)	MAX	137.8 (3,500)	118.1 (3,000)	98.5 (2,500)
118.1 (3,000)	1,675 (760)	1,609 (730)	1,653 (750)		1,212 (550)	1,609 (730)	1,653 (750)		1,058 (480)	1,345 (610)	1,565 (710)	
78.7 (2,000)	1,719 (780)	1,896 (860)	2,072 (940)	2,447 (1,110)	1,014 (460)	1,477 (670)	2,072 (940)	2,447 (1,110)	882 (400)	1,279 (580)	1,543 (700)	2,227 (1,010)
39.4 (1,000)	1,830 (830)	2,336 (1,060)	2,844 (1,290)	3,726 (1,690)	948 (430)	1,389 (630)	1,742 (790)	2,271 (1,030)	838 (380)	1,234 (560)	1,410 (640)	1,962 (890)
Ground (0)	1,918 (870)	2,535 (1,150)	3,153 (1,430)	3,968 (1,800)	970 (440)	1,323 (600)	1,653 (750)	2,116 (960)	860 (390)	1,168 (530)	1,322 (600)	1,786 (810)
-39.4 (-1,000)	2,006 (910)	2,601 (1,080)	2,932 (1,330)	3,615 (1,640)	992 (510)	1,301 (590)	1,609 (730)	2,072 (940)	992 (450)	1,124 (510)	1,322 (600)	1,764 (800)
-59.1 (-1,500)	2,006 (910)		2,579 (1,170)	3,153 (1,430)	1,168 (610)		1,609 (730)	2,072 (940)	1,168 (530)		1,344 (610)	1,808 (820)
-78.7 (-2,000)	1,940 (880)			2,403 (1,090)	1,543 (760)			2,403 (1,090)	1,543 (700)			1,852 (840)

**Dimensions - ViO35-7**

- A** 7 ft. 3 in. (2,210 mm)
- B** 15 ft. 5 in. (4,720 mm)
- C** 17 ft. 4 in. (5,300 mm)
- D** 17 ft. 9 in. (5,430 mm)
- E** 7 ft. 1 in. (2,160 mm)
- F** 5 ft. 5 in. (1,680 mm)
- G** 1 ft. 2 in. (370 mm)
- H** 1 ft. 4 in. (425 mm)
- I** 11 ft. 3 in. (3,430 mm)
- J** 8 ft. 3 in. (2,530 mm)
- K** 10 ft. 8 in. (3,250 mm)
- L** 16 ft. 11 in. (5,180 mm)
- M** 11 ft. 2 in. (3,410 mm)
- N** 4 ft. 1 in. (1,240 mm)
- O** 11.8 in. (300 mm)
- P** 1 ft. 11 in. (600 mm)
- Q** 7.1 in. (180 mm)
- R** 5 ft. 9 in. (1,740 mm)
- S** 8 ft. (2,460 mm)
- T** 4 ft. 8 in. (1,440 mm)
- U** 5 ft. 9 in. (1,740 mm)
- V** 5 ft. 9 in. (1,740 mm)
- W** 2 ft. 10 in. (870 mm)
- Y** 1 ft. (320 mm)

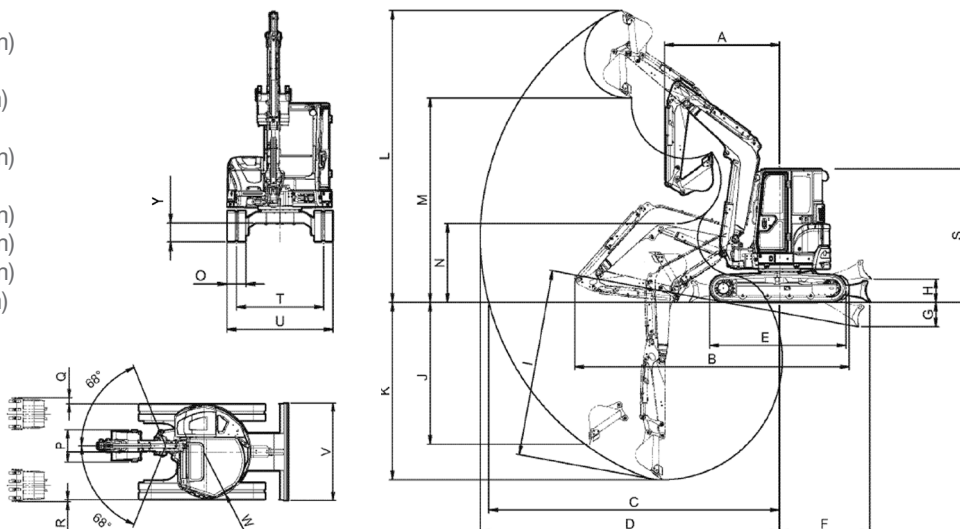

Find more information on the ViO35-7 at [YanmarCE.com](http://YanmarCE.com).